

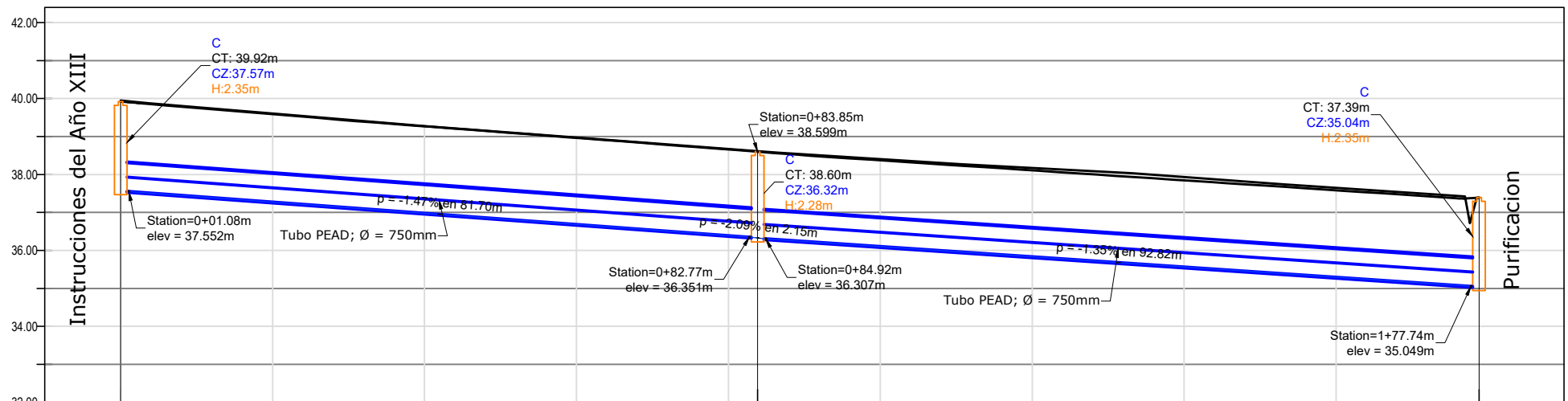

Perfil Longitudinal: Red Tuberia F. Argento (1) PLUVIAL; deformacion H:V = 5



Progresivas	0 KM 000	0 KM 010	0 KM 020	0 KM 030	0 KM 040	0 KM 050	0 KM 060	0 KM 070	0 KM 080	0 KM 090	0 KM 100	0 KM 110	0 KM 120	0 KM 130	0 KM 140	0 KM 150	0 KM 160	0 KM 170	0 KM 180	0 KM 190
Terreno existente		39.77	39.61	39.44	39.28	39.13	38.97	38.82	38.67	38.53	38.40	38.28	38.17	38.07	37.93	37.78	37.65	37.51		
Eje Proyecto		39.75	39.59	39.42	39.27	39.12	38.96	38.81	38.66	38.50	38.37	38.24	38.11	37.98	37.85	37.71	37.58	37.45		
Desmote		0.02	0.02	0.02	0.01	0.01	0.01	0.01	0.02	0.03	0.03	0.04	0.06	0.09	0.09	0.07	0.06	0.06		
Terraplén																				
Prof. Pluvial		2.35	2.33	2.31	2.30	2.29	2.29	2.29	2.28	2.29	2.30	2.31	2.34	2.37	2.37	2.36	2.35	2.35		



INTENDENCIA
DEPARTAMENTAL
DE PAYSANDÚ



PDU
PAYSANDÚ
TIERRA HEROICA



UNIDAD
TÉCNICA DE
PROYECTO

OBRA: URBANIZACION BARRIO CHAPLIN	Lámina: L/17
Lámina : PLANO PLANTA Y PERFIL LONGITUDINAL CALLE F. Argento - Pluvial	Escala 1:400
Técnicos: Ing. Civil Gustavo Belvisi - Marcelo Gonzalez Ing. Civil Diego Belvisi	Ing. Eduardo Costa